

Station Name			Station Location				Station Number	
Mt DIRECTION			Dalrymple Rd, Mt Direction (Nr Int East Arm Rd				8000	
STATION INFORMATION						MARK DETAIL		
Coordinate	519724.33E	5438723.70	m	Datum	AMG Z55-AGD66			
Elevation		92.456	m	Datum	AHD83 (Tas)			
Gravity			mGals	Datum	ISO GAL65			
Station Type	GPS Reference Base							
Estab. By	AUSPOS							
Placed By	Integrated Mapping Technologies P/L			Date	17/12/07			
Mark Desc'n	60cm SIP deep driven to ground level with 1.5m SIP witness post adjacent to fence corner							

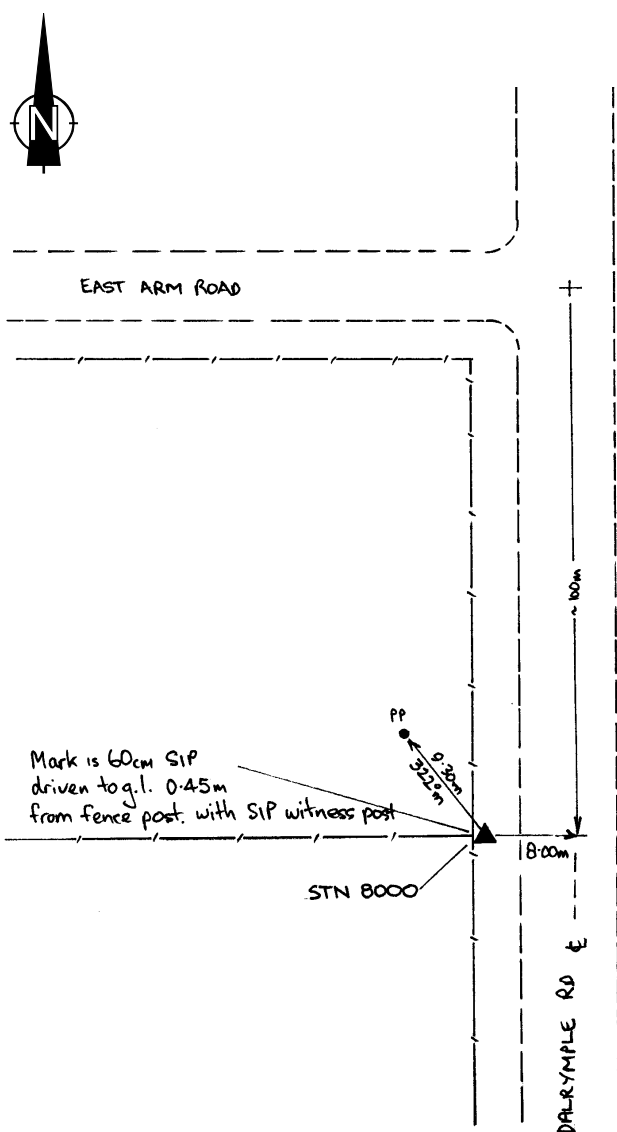

Looking South



Looking North

Station Name				Station Location				Station Number	
BRIDPORT AIRSTRIP				Access road to Bridport airstrip				8001	
STATION INFORMATION						MARK DETAIL			
Coordinate	534025.69	5458526.34	m	Datum	AMG Z55-AGD66				
Elevation		14.725	m	Datum	AHD83 (Tas)				
Gravity			mGals	Datum					
Station Type	GPS Reference Station								
Estab. By	AUSPOS								
Placed By	Integrated Mapping Technologies P/L			Date	20/12/07				
Mark Desc'n	60cm SIP deep driven to ground level with 1.5m SIP witness post adjacent to fence corner.								



Looking East



Looking West

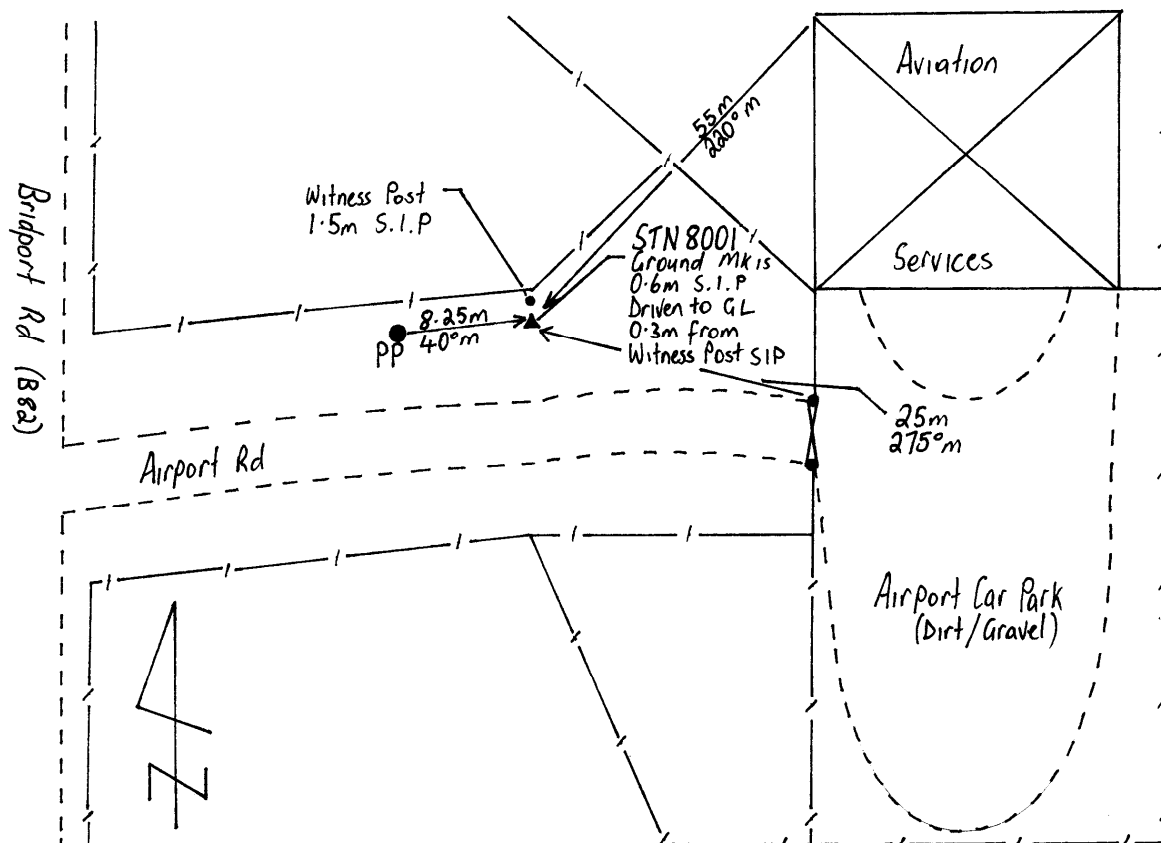

Station Name			Station Location				Station Number
WATERHOUSE			Waterhouse Road, Nr Waterhouse				8002
STATION INFORMATION						MARK DETAIL	
Coordinate	552064.68E	5469096.84N	m	Datum	AMG Z55-AGD66		
Elevation		37.037	m	Datum	AHD83 (Tas)		
Gravity			mGals	Datum			
Station Type	GPS Reference Station						
Estab. By	AUSPOS						
Placed By	Integrated Mapping Technologies P/L			Date	22/12/07		
Mark Desc'n	60cm SIP deep driven to ground level with 1.5m SIP witness post adjacent to fence corner						



Looking West



Looking North

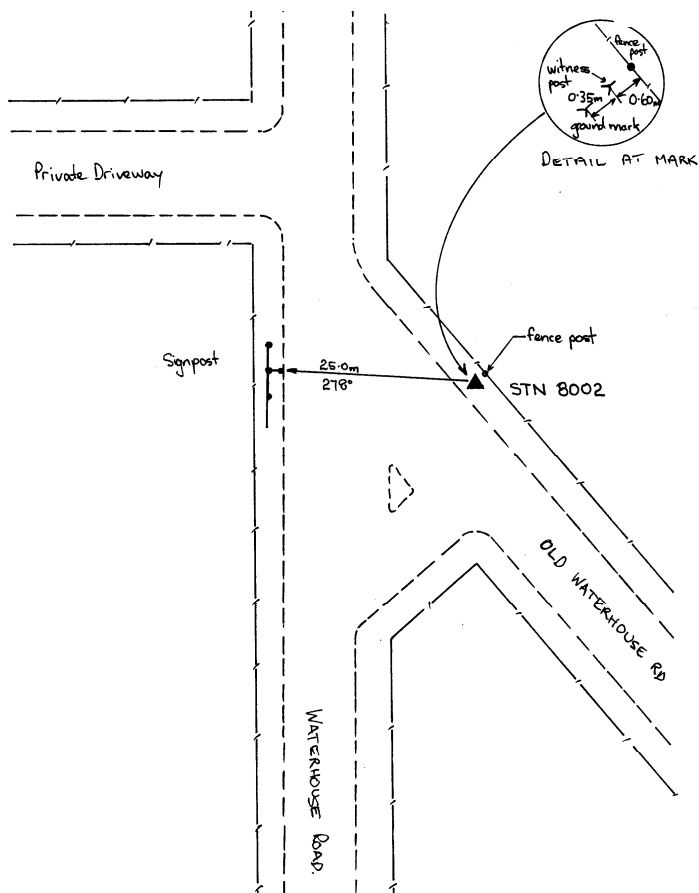

Station Name			Station Location				Station Number	
NUNAMARRA			Tasman Hwy, Nr Burke Rd Int, Nunamarra				8003	
STATION INFORMATION						MARK DETAIL		
Coordinate	527953.53E	5420797.59N	m	Datum	AMG Z55-AGD66			
Elevation		376.889	m	Datum	AHD83 (Tas)			
Gravity			mGals	Datum	ISOGAL65			
Station Type	GPS Reference Station							
Estab. By	AUSPOS							
Placed By	Integrated Mapping Technologies P/L			Date	04/01/08			
Mark Desc'n	60cm SIP deep driven to ground level with 1.5m SIP witness post adjacent to fence corner							



Looking North



Looking South

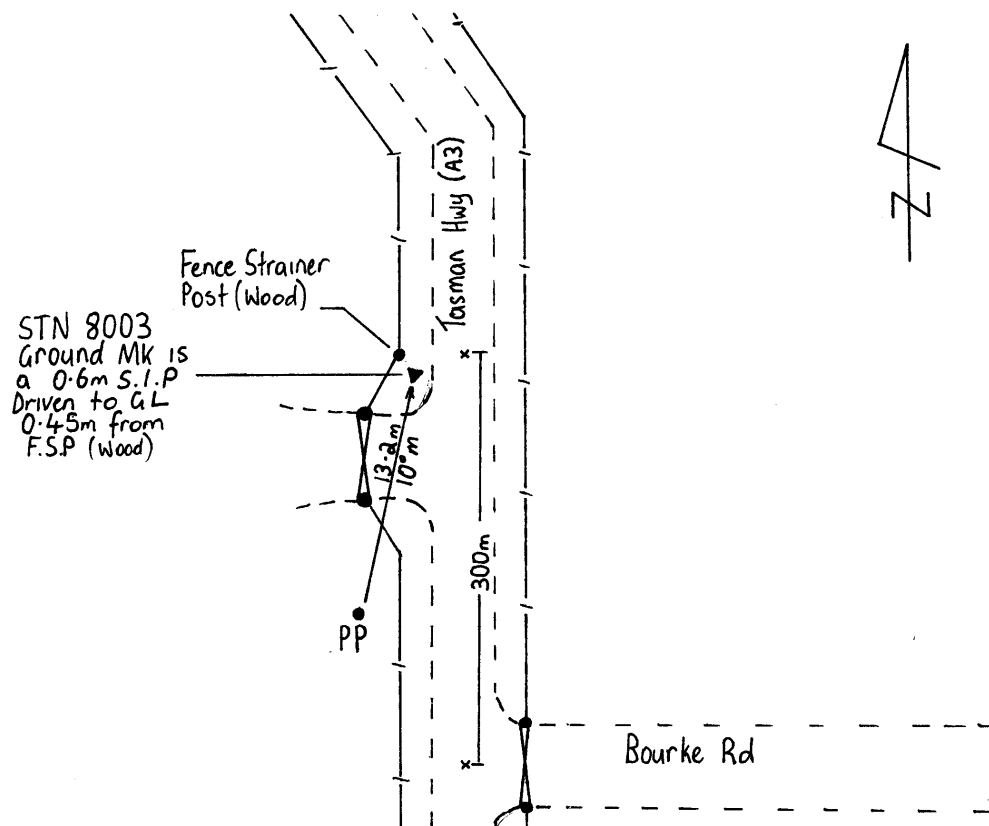

Station Name			Station Location				Station Number
LILYDALE			Second River Rd, Lilydale				8004
STATION INFORMATION						MARK DETAIL	
Coordinate	517351.15E	5434673.29N	m	Datum	AMG Z55-AGD66		
Elevation		161.827	m	Datum	AHD83 (Tas)		
Gravity			mGals	Datum	ISOGAL65		
Station Type	GPS Reference Station						
Estab. By	AUSPOS						
Placed By	Integrated Mapping Technologies P/L			Date	11/01/08		
Mark Desc'n	60cm SIP deep driven to ground level with 1.5m SIP witness post adjacent to fence corner						

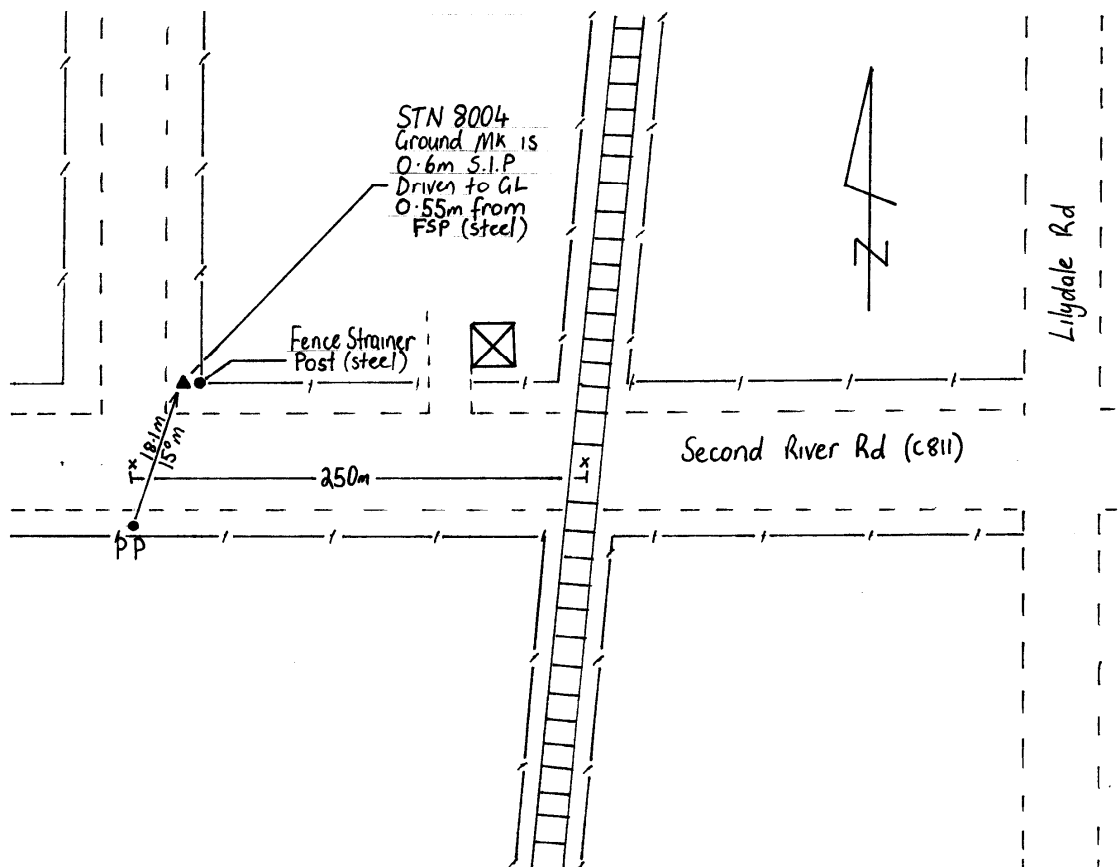

Station Name			Station Location				Station Number	
PIPERS BROOK			Bellingham Rd, Pipers Brook				8005	
STATION INFORMATION						MARK DETAIL		
Coordinate	514982.97E	5454606.64N	m	Datum	AMG Z55-AGD66			
Elevation		107.651	m	Datum	AHD83 (Tas)			
Gravity			mGals	Datum	ISOGAL65			
Station Type	GPS Reference Station							
Estab. By	AUSPOS							
Placed By	Integrated Mapping Technologies P/L			Date	16/01/08			
Mark Desc'n	60cm SIP deep driven to ground level with 1.5m SIP witness post adjacent to fence corner							

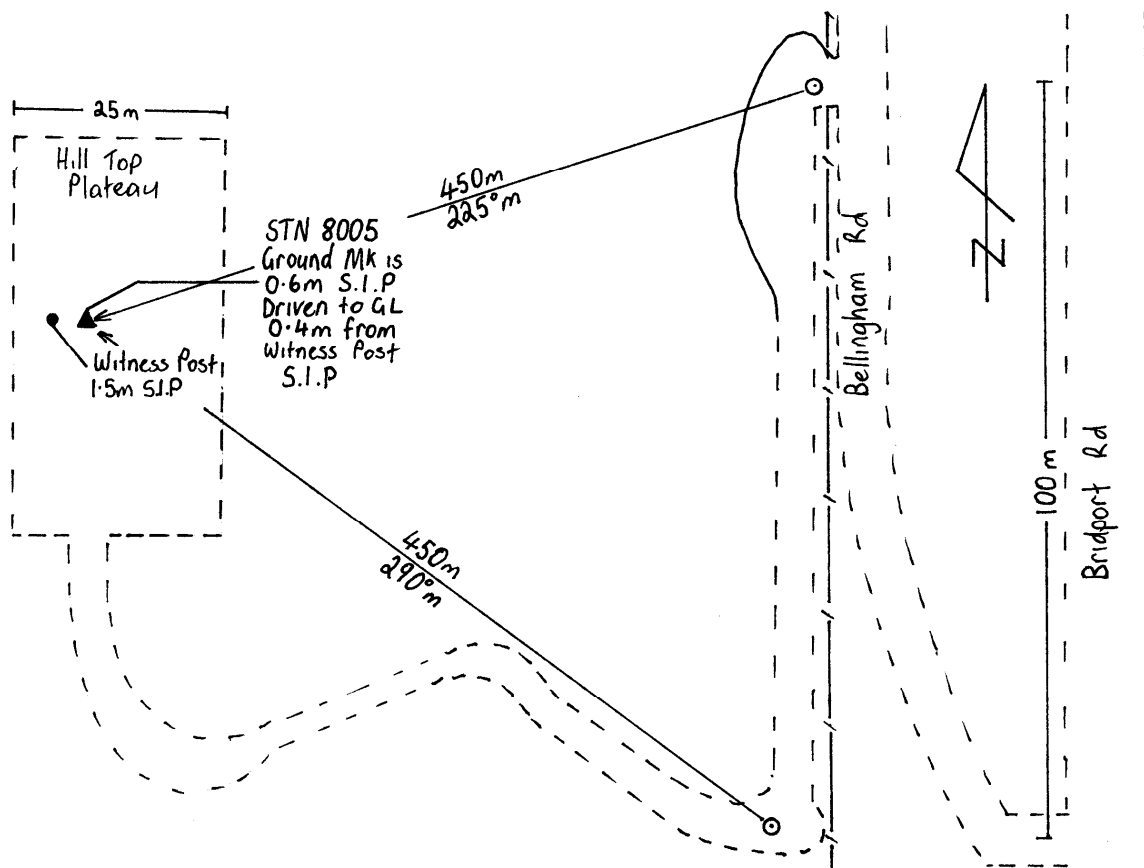

Station Name			Station Location				Station Number
FERNY HILL			In paddock near Ferny Hill Rd, Ferny Hill				8006
STATION INFORMATION						MARK DETAIL	
Coordinate	524822.99E	5451995.31N	m	Datum	AMG Z55-AGD66		
Elevation		134.190	m	Datum	AHD83 (Tas)		
Gravity			mGals	Datum	ISOGAL65		
Station Type	GPS Reference Station						
Estab. By	AUSPOS						
Placed By	Integrated Mapping Technologies P/L			Date	18/01/08		
Mark Desc'n	60cm SIP deep driven to ground level with 1.5m SIP witness post adjacent to fence corner						

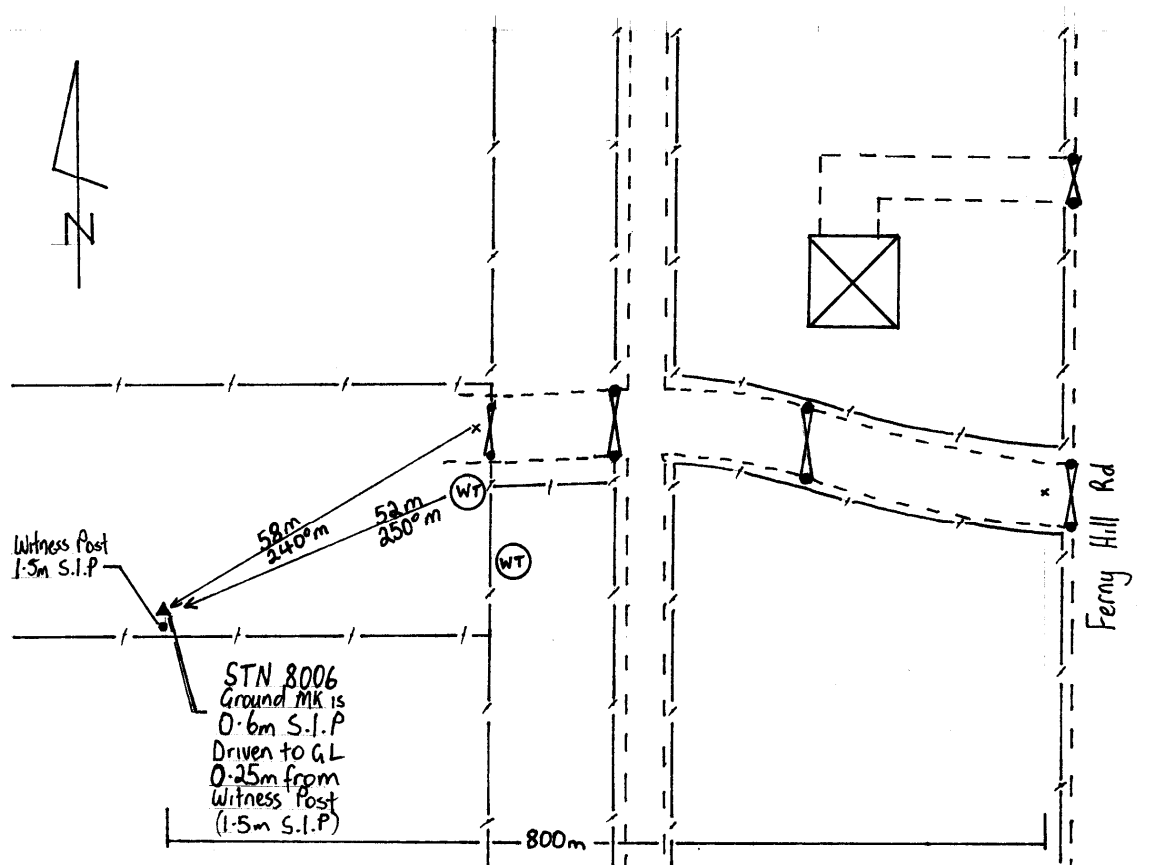

Station Name				Station Location				Station Number	
PIPERS RIVER				934 Industry Rd, Pipers River				8007	
STATION INFORMATION						MARK DETAIL			
Coordinate	506024.90E	5449403.71N	m	Datum	AMG Z55-AGD66				
Elevation		133.861	m	Datum	AHD83 (Tas)				
Gravity			mGals	Datum	ISOGAL65				
Station Type	GPS Reference Station								
Estab. By	AUSPOS								
Placed By	Integrated Mapping Technologies P/L			Date	23/02/2008				
Mark Desc'n	60cm SIP deep driven to ground level with 1.5m SIP witness post adjacent to fence corner								

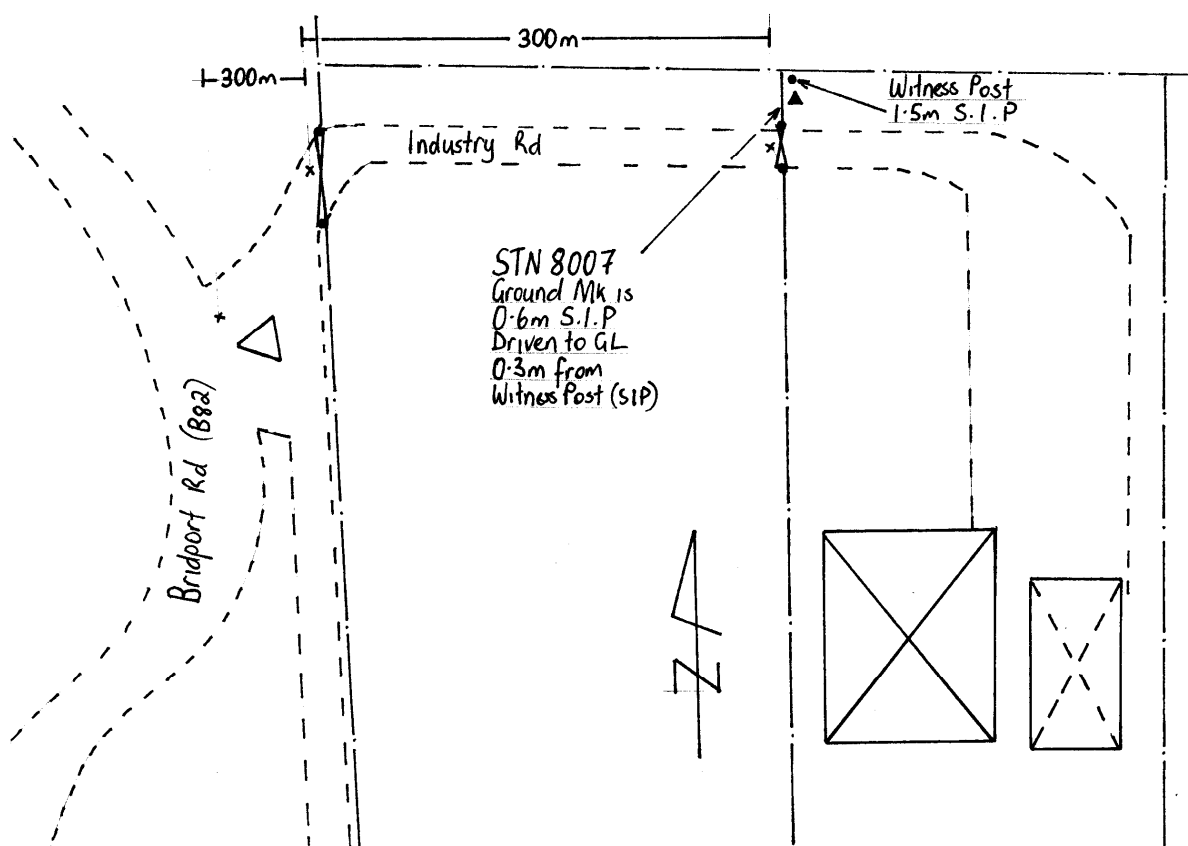

Station Name				Station Location				Station Number	
SPRINGFIELD				35992 Tasman Hwy, Springfield				8008	
STATION INFORMATION						MARK DETAIL			
Coordinate	539858.90E	5437332.05N	m	Datum	AMG Z55-AGD66				
Elevation		252.825	m	Datum	AHD83 (Tas)				
Gravity			mGals	Datum	ISOGAL65				
Station Type	GPS Reference Station								
Estab. By	AUSPOS								
Placed By	Integrated Mapping Technologies P/L			Date	24/01/2008				
Mark Desc'n	60cm SIP deep driven to ground level with 1.5m SIP witness post adjacent to fence corner								



Station Name			Station Location				Station Number
BILLY-COCK HILL			Billy-Cock Hill Radio Tower, off Tasman Hwy Tullendeena				8009
STATION INFORMATION						MARK DETAIL	
Coordinate	556323.60E	5438568.33N	m	Datum	AMG Z55-AGD66		
Elevation		410.397	m	Datum	AHD83 (Tas)		
Gravity			mGals	Datum	ISOGAL65		
Station Type	GPS Reference Station						
Estab. By	AUSPOS						
Placed By	Integrated Mapping Technologies P/L			Date	26/01/2008		
Mark Desc'n	60cm SIP deep driven to ground level with 1.5m SIP witness post adjacent to fence corner						

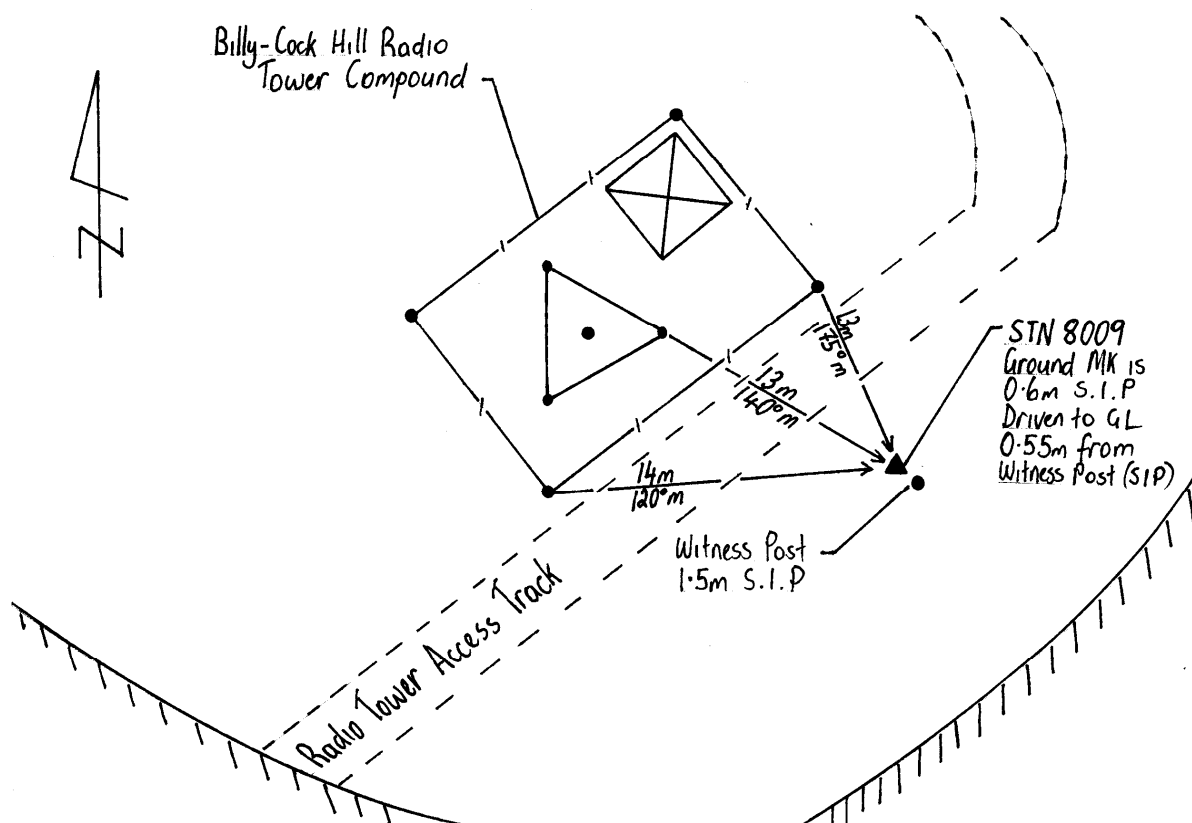

Station Name				Station Location				Station Number	
MOUNT HORROR				Fire Tower				8010	
STATION INFORMATION						MARK DETAIL			
Coordinate	561489.15E	5453353.53N	m	Datum	AMG Z55-AGD66				
Elevation		675.302	m	Datum	AHD83 (Tas)				
Gravity			mGals	Datum	ISOGAL65				
Station Type	Combined GPS Reference and Gravity Base								
Estab. By	AUSPOS for Position, ABABA tie for gravity								
Placed By	Integrated Mapping Technologies P/L			Date	30/01/2008				
Mark Desc'n	60cm SIP deep driven to ground level with 1.5m SIP witness post adjacent to fence corner								

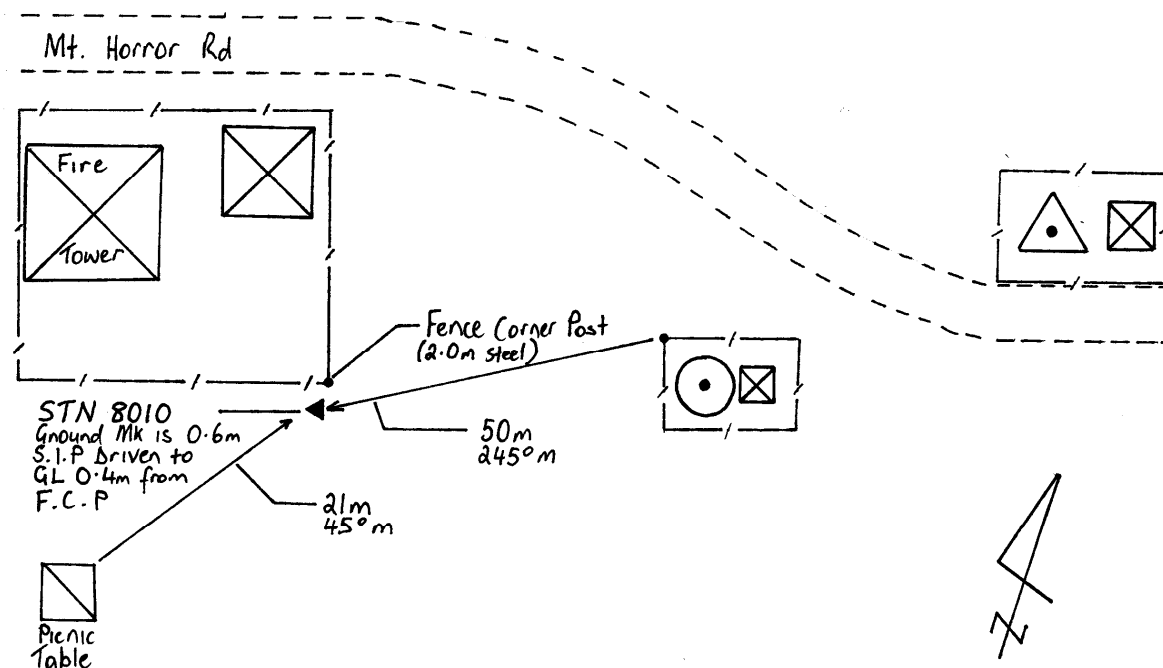

Station Name			Station Location				Station Number	
WATERY PLAINS			"Watery Plains", Nr Int. Blessington & Watery Plains Rd, Blessington				8011	
STATION INFORMATION						MARK DETAIL		
Coordinate	529961.31E	5405041.91N	m	Datum	AMG Z55-AGD66			
Elevation		366.469	m	Datum	AHD83 (Tas)			
Gravity			mGals	Datum	ISOGAL65			
Station Type	GPS Reference Station							
Estab. By	AUSPOS							
Placed By	Integrated Mapping Technologies P/L			Date	23/02/2008			
Mark Desc'n	60cm SIP deep driven to ground level with 1.5m SIP witness post adjacent to fence corner							

